

American Champion Aircraft Corp.
Rochester, WI 53167

Service Letter: 437

Date: August 14, 2012

Title: One-Time Inspection of Folding Front Seat Bottom

Applicable Models: All Model 7EC, serial numbers 1000-2006 through 1032-2011
All Model 7ECA, serial numbers 1355-95 through 1408-2011
All Model 7GCAA, serial numbers 400-97 through 520-2010
All Model 7GCBC, serial numbers 1200-94 through 1466-2012
All Model 8KCAB, serial numbers 643-90 through 1114-2012
All Model 8GCBC, serial numbers 361-92 through 548-2012

All older 7AC, 7ACA, S7AC, 7BCM, 7CCM, S7CCM, 7DC, S7DC, 7EC, S7EC, 7ECA, 7FC, 7GC, 7GCA, 7GCAA, 7GCB, 7GCBA, 7GCBC, 7HC, 7JC, 7KC, 7KCAB, 8KCAB, and 8GCBC with Folding Front Seats that have complied with AD 89-18-06 via replacement seat frame 7-1513 (adjustable) or 7-1454 (fixed) before the date of this letter.

Description: During an isolated case of a front seat failure, it was discovered a small batch of seat frames did not contain the required 2-2166 reinforcement truss. That batch has been isolated and the problem resolved. In an effort to ensure this has not happened in the past, American Champion requests a one time inspection of the assembly.

Note: This inspection does not replace the requirements of AD 89-18-06.

The inspection procedures described herein are not intended to be a substitute for a properly performed 100 hour / annual inspection. Refer to Advisory Circular (AC) 43.13-1B: Acceptable Methods, Techniques, and Practices: Aircraft Inspection and Repair.

Procedure: No removal of parts should be necessary to do the inspection. Referring to Figure 1, visually inspect both sides of the front seat bottom for the indicated truss section. If a 2-2166 truss is missing, contact American Champion for corrective action options.

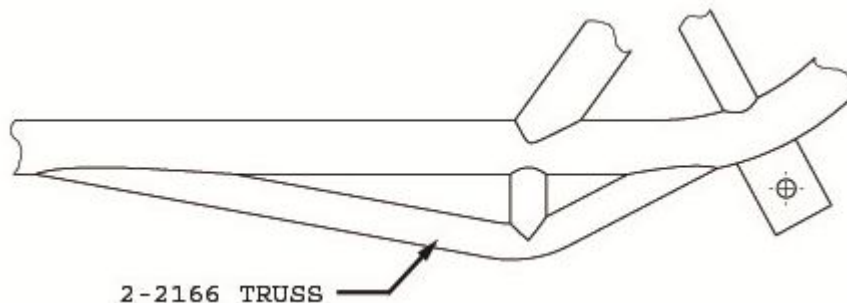

Figure 1 Location of 2-2166 Reinforcement Truss